



INSTALLATION INSTRUCTIONS

MODEL: CRFD I-C Pack

Inline Pack for Craftsman Series Framed Swing Door Enclosure

When ordering repair parts, please provide the following information:

1. Model Number
2. Part Number
3. Part Description
4. Finish Color

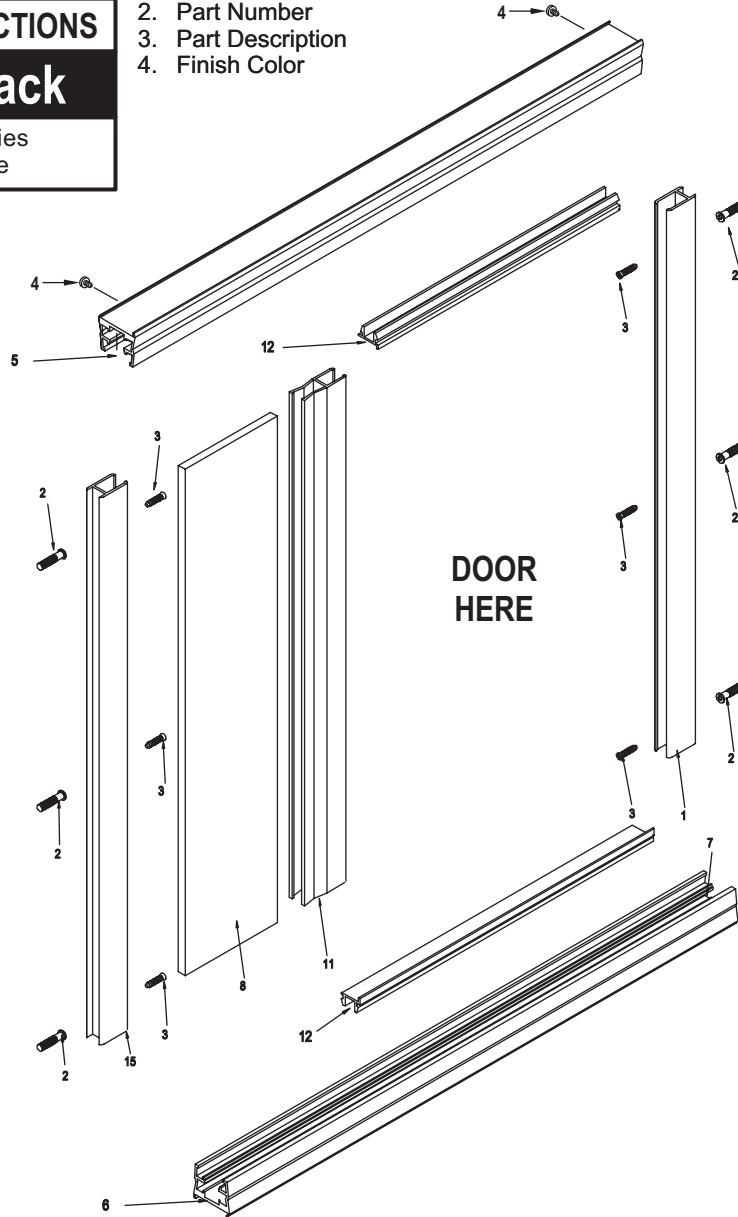

DESCRIPTION	QTY	PART NO.	PICTURE
1. Wall Channels*	2	ZD-1006	
2. Wall Anchors*	6	ZV-935	
3. #8 x 1-1/4" Screws*	6	#8X1-1/4	
4. #6 x 3/8 Screws	8	#6X3/8	
5. Headers	1	ZSS-3101	
6. Curbs	1	ZSS-3101	
7. Glass Support Blocks	1	ZV-902	
8. Inline Glass Panel	1		
9. Vertical Seal Vinyl	4	ZV-909	
10. Horizontal Seal Vinyl	4	ZV-906	
11. Inline Posts	1	ZSS-1103	
12. Header and Curb Fillers	2	ZSS-1102	

*Note: Items 1, 2 and 3 come with door stall wrap

REQUIRED TOOLS

To install your shower enclosure, you will need the following:

- Level
- #31 Drill Bit
- 3/16" Carbide Drill Bit (for tile walls)
- Phillips Screwdriver
- Silicone
- Hack Saw
- 1/4" Box End Wrench

This page intentionally left blank